

SY16C Hydraulic Excavator



KEY FEATURES

- Convenient service points for easy maintenance.
- Short tail swing is ideal for tight job sites and working in confined spaces
- Lines are run down the boom and arm as standard equipment for easy fit-up and running of hydraulic attachments
- Load sensing hydraulics for increased fuel efficiency and maximized performance
- Hydraulically extendable undercarriage with adjustable front blade width standard

Rated Power

15 hp / 11.2 kW

Dig Depth

7' 2" / 2360 mm

Operating Weight

4,023 lbf-ft / 1,825 kg

Bucket Breakout

3,417 lbf / 15.2 kN

SY16C Dimensions & Specifications

OVERALL DIMENSIONS

	Standard	Metric
A Transport Length	11' 7"	3575 mm
B Transport Width	3' 2" / 4' 5"	980 / 1350 mm
C Transport Height	7' 11"	2420 mm
D Top Width	6' 2"	980 mm
E Platform Height	1' 6"	470 mm
F Engine Cover Height	4' 2"	1280 mm
G Tail Swing Radius	3' 0"	920 mm
H Track Ground Length	4' 0"	1225 mm
I Track Length	5' 2"	1585 mm
J Track Gauge	2' 5" / 3' 8"	750 / 1120 mm
K Standard Track Shoe Width	0' 10"	230 mm
L Dozer Blade Height	0' 11"	270 mm
M Dozer Blade Max. Height	1' 0"	310 mm
N Dozer Blade Max Depth	1' 0"	320 mm

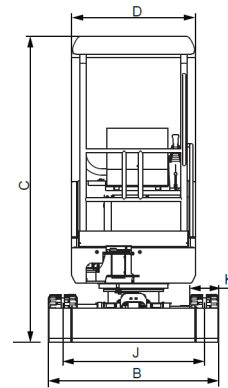
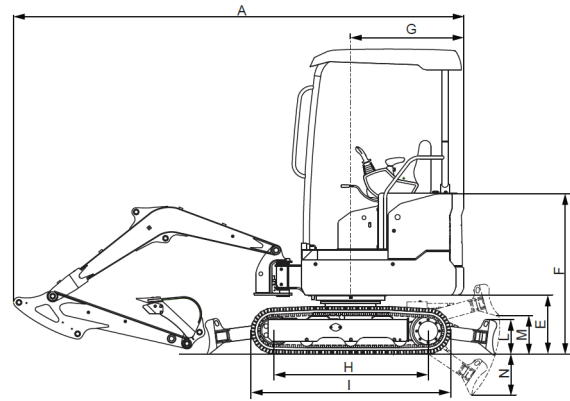

WORKING RANGE

	Standard	Metric
a Maximum Digging Height	12' 3"	3665 mm
b Maximum Dumping Height	8' 8"	2635 mm
c Maximum Digging Depth	7' 9"	2360 mm
d Maximum Vertical Wall Digging Depth	7' 3"	2215 mm
e Maximum Digging Reach	13' 1"	4000 mm
f Minimum Swing Radius	5' 5"	1655 mm
g Maximum Height at Minimum Swing Radius	9' 1"	2745 mm

MACHINE PARAMETERS

Operating Weight	4,023 lb (1825 kg)
Engine Type	Yanmar 3TNV74F Tier 4 final
Engine Max Power (Gross)	15.0 hp (11.2 kW) @ 2400rpm
Engine Max Torque	38.2 lbf-ft (51.8 Nm) @ 1800 rpm
Engine Displacement	60.6 in ³ (0.993 liter)
Alternator	40A/12V
Main Pump Flow	12.7 gpm (48 lpm)
Swing Speed	10 rpm
Travel Speed	1.3/2.1 mph (2.1/3.7 km/h)
Tractive Effort	3,507 lbf (15.6 kN)
Max Arm Digging Force (SAE)	2,068 lbf (9.2 kN)
Number of Upper Rollers	2
Number of Lower Rollers	3
Fuel Tank Capacity	6.1 gal (23 liter)
Hydraulic Tank Capacity	5.5 gal (21 liter)
Cooling System Capacity	1.0 gal (3.8 liter)
Engine Oil Capacity	0.5 gal (2.0 liter)
Ground Pressure (31.5"/800mm shoes)	4.2 psi (29 kPa)

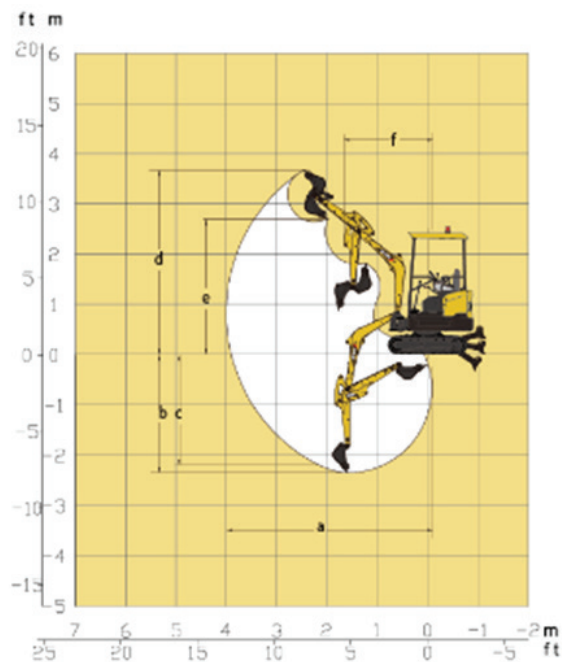

SANY America Inc.

318 Cooper Circle | Peachtree City, GA 30269
T: 678-251-2810 | F: 770-632-7820

www.sanyamerica.com

